

Printed 7/22/2023

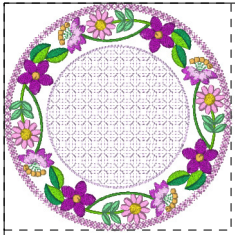

- 1. Lavender
- 2. Lilac
- 3. Leaf Green
- 4. Lime Green
- 5. Teal Green
- 6. Mint Green
- 7. Pink
- 8. Violet
- 9. Light Lilac
- 10. magenta2
- 11. Harvest Gold
- 12. Deep Gold

**Ajd220\_aljay\_gb6x10s101.pes**  
5.57x5.57 inches; 22,486 stitches  
12 thread changes; 12 colors

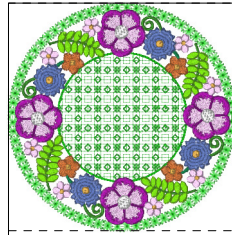

- 1. moss green2
- 2. Leaf Green
- 3. Lime Green
- 4. Teal Green
- 5. cornflower blue2
- 6. Light Lilac
- 7. magenta2
- 8. Amber Red
- 9. Light Lilac
- 10. Deep Gold
- 11. White

**Ajd220\_aljay\_gb6x10s102.pes**  
5.58x5.58 inches; 25,542 stitches  
11 thread changes; 10 colors

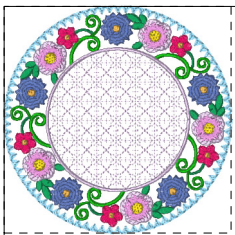

- 1. Teal Green
- 2. moss green2
- 3. Lavender
- 4. Sky Blue
- 5. Lavender
- 6. Lilac
- 7. Harvest Gold
- 8. cornflower blue2
- 9. Deep Rose
- 10. Deep Gold

**Ajd220\_aljay\_gb6x10s103.pes**  
5.57x5.56 inches; 21,856 stitches  
10 thread changes; 9 colors

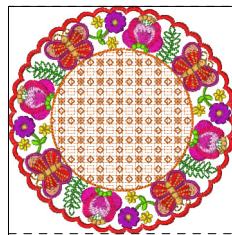

- 1. Leaf Green
- 2. Vermilion
- 3. Red
- 4. deep rose2
- 5. Deep Rose
- 6. Leaf Green
- 7. Flesh Pink
- 8. Dark Fuchsia
- 9. Harvest Gold
- 10. Salmon Pink
- 11. Red
- 12. Lime Green
- 13. magenta2
- 14. Deep Gold
- 15. Dark Fuchsia
- 16. Clay Brown
- 17. Deep Gold

**Ajd220\_aljay\_gb6x10s104.pes**  
5.57x5.57 inches; 26,072 stitches  
17 thread changes; 13 colors

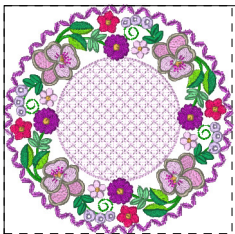

- 1. Violet
- 2. Light Lilac
- 3. moss green2
- 4. Mint Green
- 5. Lime Green
- 6. Teal Green
- 7. lilac2
- 8. magenta2
- 9. Pink
- 10. Light Lilac
- 11. Royal Purple
- 12. Silver
- 13. Light Lilac
- 14. Deep Rose
- 15. Deep Gold
- 16. White

**Ajd220\_aljay\_gb6x10s105.pes**  
5.59x5.59 inches; 31,830 stitches  
16 thread changes; 14 colors

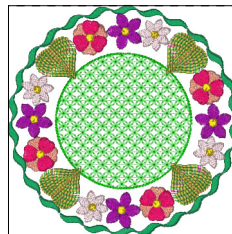

- 1. moss green2
- 2. Teal Green
- 3. Salmon Pink
- 4. Deep Rose
- 5. magenta2
- 6. flesh pink2
- 7. Harvest Gold
- 8. Leaf Green
- 9. Dark Fuchsia
- 10. Lime Green
- 11. Leaf Green
- 12. Deep Gold

**Ajd220\_aljay\_gb6x10s106.pes**  
5.65x5.67 inches; 20,213 stitches  
12 thread changes; 11 colors

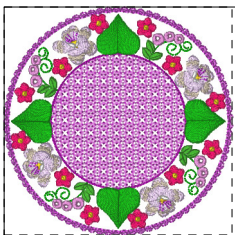

- 1. Violet
- 2. moss green2
- 3. magenta2
- 4. moss green2
- 5. Leaf Green
- 6. Lilac
- 7. Lavender
- 8. Warm Gray
- 9. Lavender
- 10. Purple
- 11. Deep Rose
- 12. Harvest Gold
- 13. White

**Ajd220\_aljay\_sample.pes**  
5.59x5.59 inches; 27,106 stitches  
13 thread changes; 11 colors