



Design Worksheet

Zoom: 0.48

BERNINA Embroidery  
Software DesignerPlus



Name: BBISBigFlowerBlock10x10.ART

Height: 231.3 mm  
Width: 249.9 mm  
Stitches: 38855  
Colors: 9  
Color changes: 9  
Trims: 155  
Machine format: Bernina  
Hoop: Medium (180 x 130)  
Total bobbin: 90.12m

Color Sequence:

#	Color	Code	Name	Chart
1.	8	1770	Light Emerald Green	Madeira Polyneon
2.	7	1648	Celery	Madeira Polyneon
3.	4	1830	China Blue	Madeira Polyneon
4.	2	1922	Regal Purple	Madeira Polyneon
5.	1	1709	Shocking Pink	Madeira Polyneon
6.	10	1507	Pea Coat Lining	Madeira Polyneon
7.	3	1832	Majestic Purple	Madeira Polyneon
8.	5	1829	Blue Bird	Madeira Polyneon
9.	4	1830	China Blue	Madeira Polyneon
10.	9	1951	Pumpkin Chiffon	Madeira Polyneon

Machine runtime:

Module	Runtime (hr:min:sec)
Default	2:04:37



## Design Worksheet

BERNINA Embroidery Software DesignerPlus  
 Design: BBISBlockFlower10x10

Stitches: 47366  
 Colors: 8  
 Height: 240.2 mm  
 Width: 250.0 mm  
 Zoom: 0.50

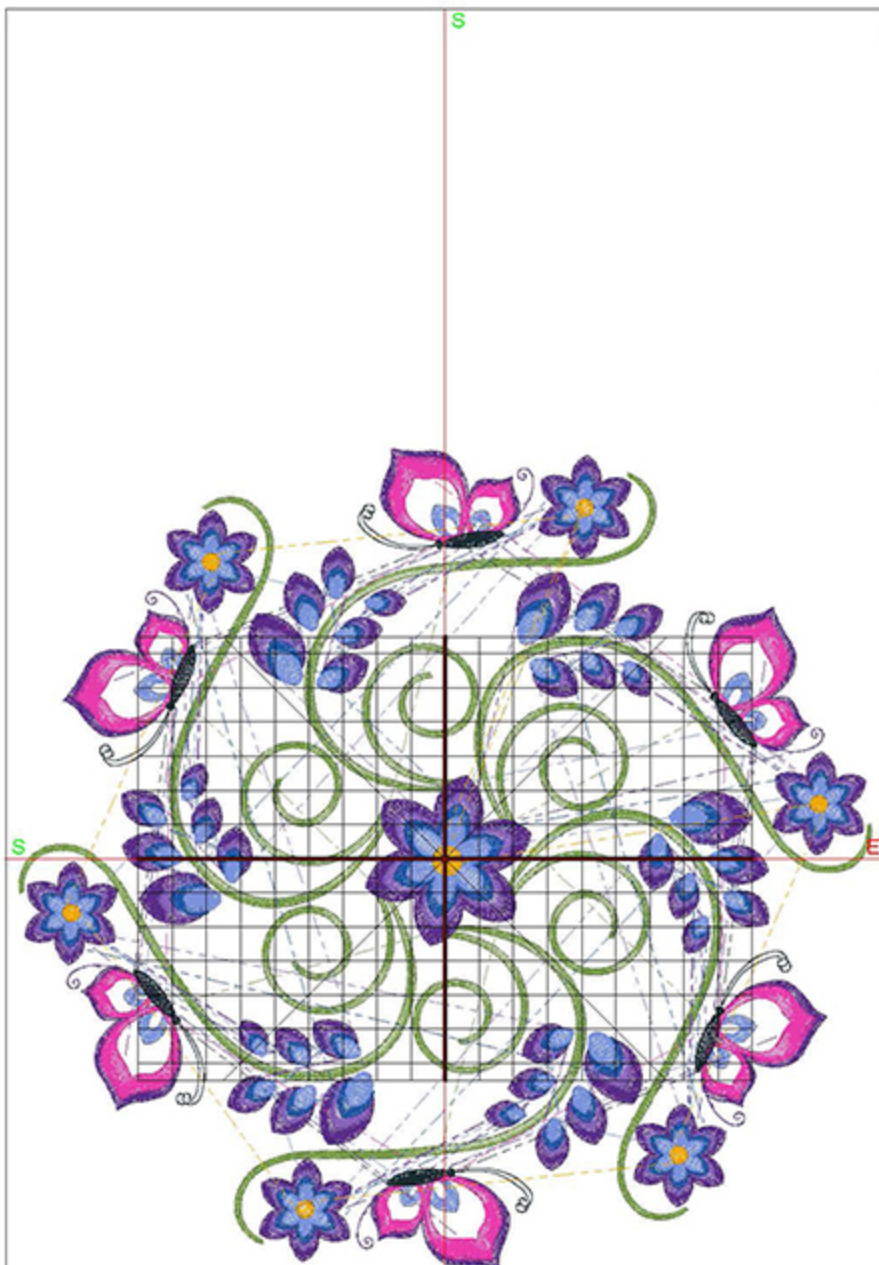

Total bobbin: 95.01m

Color Film:

#	Chart	Code	Name	Thread
1.		Madeira Polyneon	1648 Celery	47.51m
2.		Madeira Polyneon	1830 China Blue	6.09m
3.		Madeira Polyneon	1922 Regal Purple	74.12m
4.		Madeira Polyneon	1709 Shocking Pink	22.16m
5.		Madeira Polyneon	1507 Pea Coat Lining	8.00m
6.		Madeira Polyneon	1832 Majestic Purple	36.11m
7.		Madeira Polyneon	1829 Blue Bird	26.55m
8.		Madeira Polyneon	1830 China Blue	31.75m
9.		Madeira Polyneon	1951 Pumpkin Chiffon	2.77m

Machine runtime: 1:50:51



## Design Worksheet

BERNINA Embroidery Software DesignerPlus

Design: BBISbutterflyBlock10x10

Stitches: 42676

Colors: 9

Height: 221.7 mm

Width: 250.0 mm

Zoom: 0.47

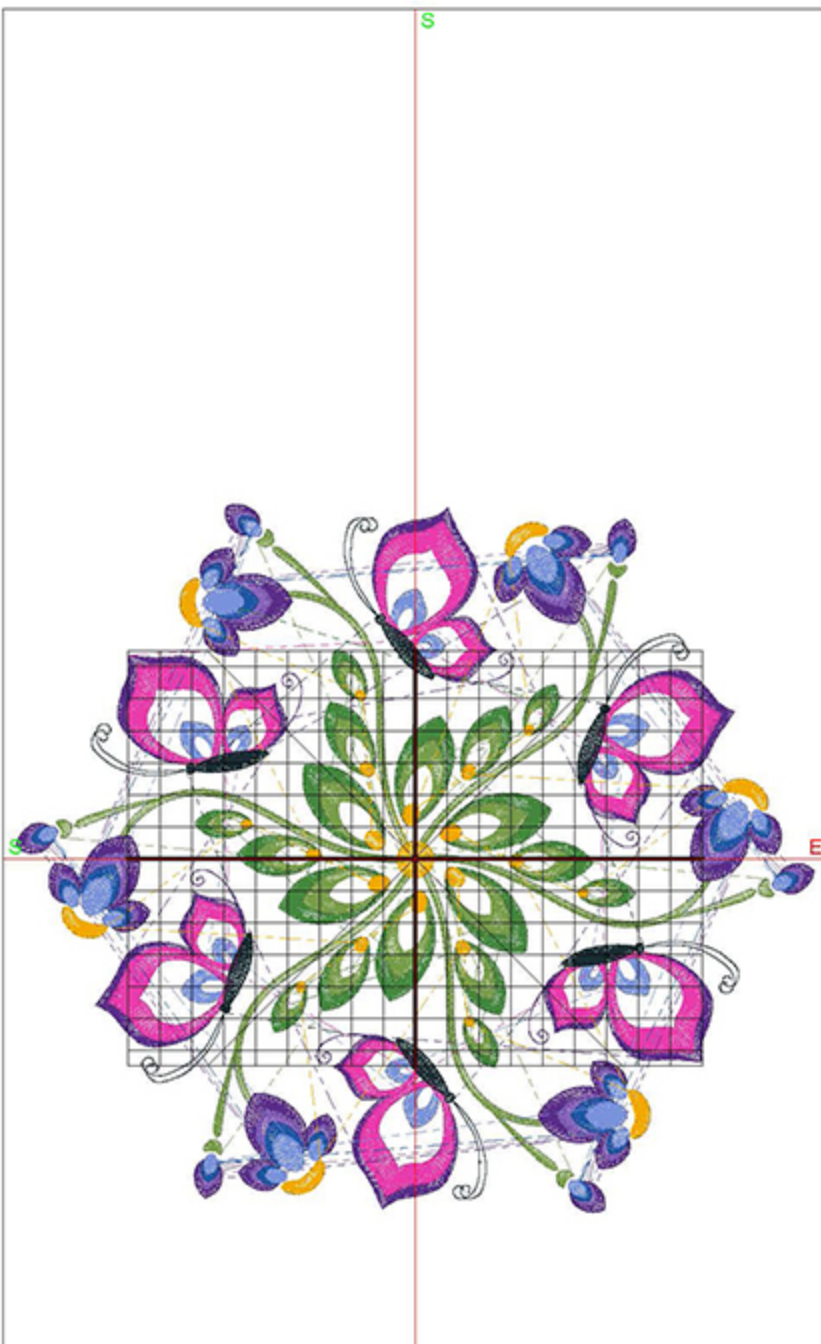

Total bobbin: 96.97m

Color Film:

#	Chart	Code	Name	Thread
1.		Madeira Polyneon 1648	Celery	17.91m
2.		Madeira Polyneon 1830	China Blue	9.24m
3.		Madeira Polyneon 1922	Regal Purple	22.45m
4.		Madeira Polyneon 1709	Shocking Pink	46.06m
5.		Madeira Polyneon 1507	Pea Coat Lining	11.84m
6.		Madeira Polyneon 1922	Regal Purple	34.15m
7.		Madeira Polyneon 1832	Majestic Purple	20.93m
8.		Madeira Polyneon 1829	Blue Bird	14.96m
9.		Madeira Polyneon 1830	China Blue	14.73m
10.		Madeira Polyneon 1770	Light Emerald Green	26.71m
11.		Madeira Polyneon 1648	Celery	19.85m
12.		Madeira Polyneon 1951	Pumpkin Chiffon	10.16m

Machine runtime: 1:34:03



Design Worksheet

Zoom: 0.51

BERNINA Embroidery  
Software DesignerPlus



Name: BBISButterflyFlower10x10.ART

Height: 250.0 mm  
 Width: 236.3 mm  
 Stitches: 57498  
 Colors: 9  
 Color changes: 10  
 Trims: 144  
 Machine format: Bernina  
 Hoop: Medium (180 x 130)  
 Total bobbin: 133.07m

Color Sequence:

#	Color	Code	Name	Chart
1.	4	1830	China Blue	Madeira Polyneon
2.	2	1922	Regal Purple	Madeira Polyneon
3.	1	1709	Shocking Pink	Madeira Polyneon
4.	10	1507	Pea Coat Lining	Madeira Polyneon
5.	3	1832	Majestic Purple	Madeira Polyneon
6.	5	1829	Blue Bird	Madeira Polyneon
7.	4	1830	China Blue	Madeira Polyneon
8.	8	1770	Light Emerald Green	Madeira Polyneon
9.	7	1648	Celery	Madeira Polyneon
10.	9	1951	Pumpkin Chiffon	Madeira Polyneon
11.	1	1709	Shocking Pink	Madeira Polyneon

Machine runtime:

Module	Runtime (hr:min:sec)
Default	2:43:34



Design Worksheet

Zoom: 0.48

BERNINA Embroidery  
Software DesignerPlus

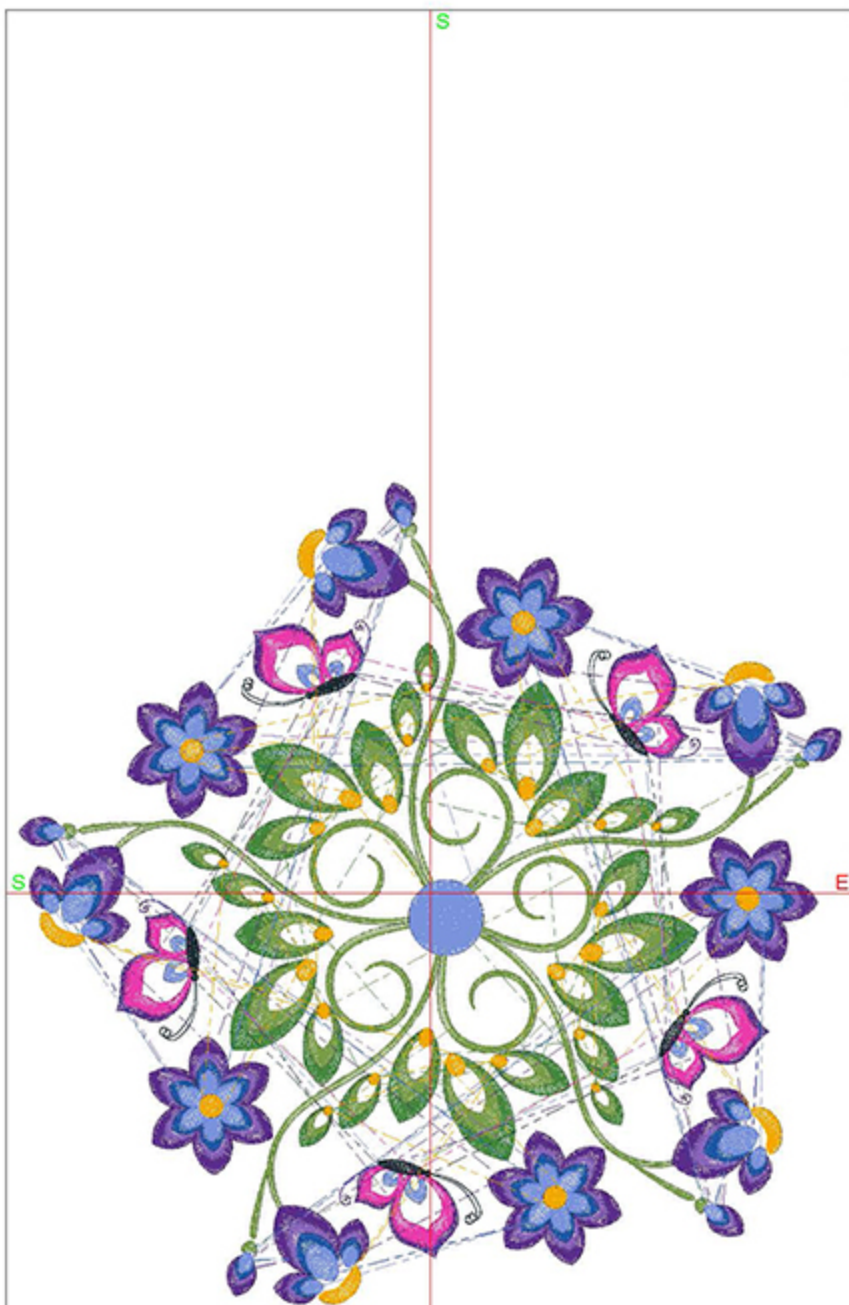

Name: BBISButterflyFlowerBlock10x10.  
ART

Height: 249.7 mm  
Width: 250.0 mm  
Stitches: 48013  
Colors: 9  
Color changes: 10  
Trims: 176  
Machine format: Bernina  
Hoop: Medium (180 x 130)  
Total bobbin: 103.29m

Color Sequence:

#	Color	Code	Name	Chart
1.	8	1770	Light Emerald Green	Madeira Polyneon
2.	7	1648	Celery	Madeira Polyneon
3.	4	1830	China Blue	Madeira Polyneon
4.	2	1922	Regal Purple	Madeira Polyneon
5.	1	1709	Shocking Pink	Madeira Polyneon
6.	10	1507	Pea Coat Lining	Madeira Polyneon
7.	2	1922	Regal Purple	Madeira Polyneon
8.	3	1832	Majestic Purple	Madeira Polyneon
9.	5	1829	Blue Bird	Madeira Polyneon
10.	4	1830	China Blue	Madeira Polyneon
11.	9	1951	Pumpkin Chiffon	Madeira Polyneon

Machine runtime:

Module	Runtime (hr:min:sec)
Default	2:30:07



Design Worksheet

Zoom: 0.48

BERNINA Embroidery  
Software DesignerPlus

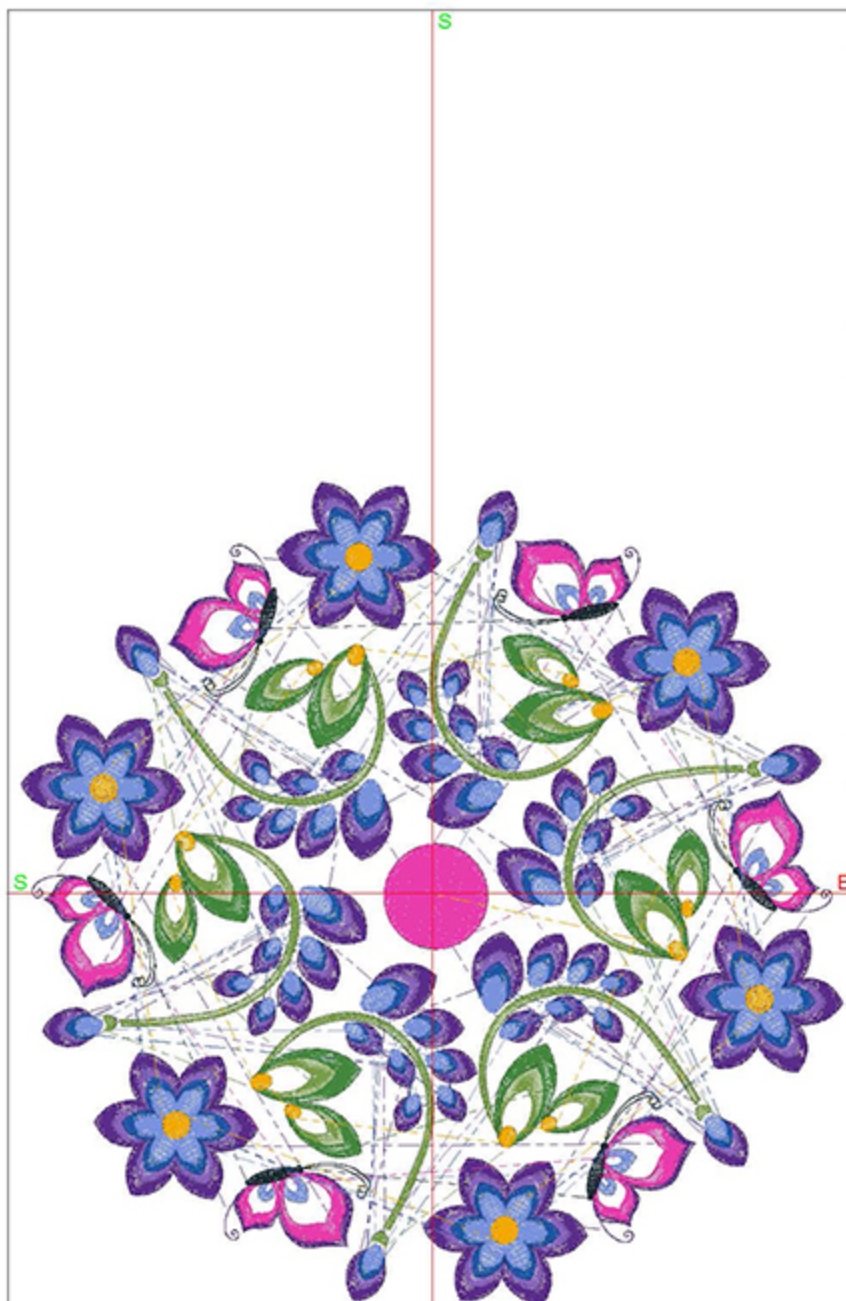

Name:BBISFivePetal10x10.ART

Height: 249.9 mm  
Width: 250.0 mm  
Stitches: 56260  
Colors: 9  
Color changes: 9  
Trims: 259  
Machine format: Bernina  
Hoop: Medium (180 x 130)  
Total bobbin: 127.80m

Color Sequence:

#	Color	Code	Name	Chart
1.	4	1830	China Blue	Madeira Polyneon
2.	2	1922	Regal Purple	Madeira Polyneon
3.	1	1709	Shocking Pink	Madeira Polyneon
4.	9	1507	Pea Coat Lining	Madeira Polyneon
5.	3	1832	Majestic Purple	Madeira Polyneon
6.	5	1829	Blue Bird	Madeira Polyneon
7.	4	1830	China Blue	Madeira Polyneon
8.	6	1648	Celery	Madeira Polyneon
9.	7	1770	Light Emerald Green	Madeira Polyneon
10.	8	1951	Pumpkin Chiffon	Madeira Polyneon

Machine runtime:

Module	Runtime (hr:min:sec)
Default	3:08:05



Design Worksheet

Zoom: 0.83

BERNINA Embroidery  
Software DesignerPlus

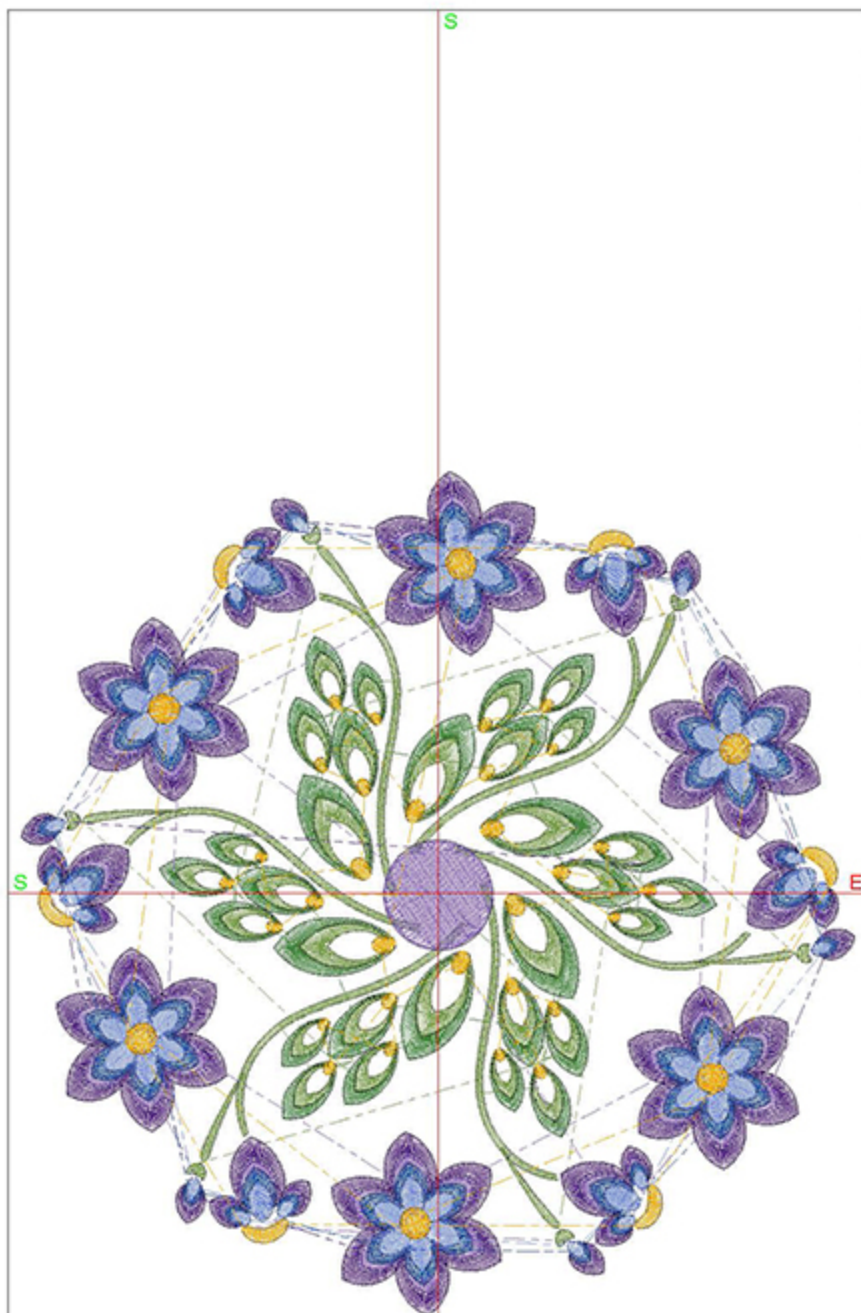

Name: BBISFlowerBlock6x6.ART

Height: 150.0 mm  
 Width: 148.2 mm  
 Stitches: 27544  
 Colors: 7  
 Color changes: 6  
 Trims: 169  
 Machine format: Bernina  
 Hoop: Medium (180 x 130)  
 Total bobbin: 43.16m

Color Sequence:

#	Color	Code	Name	Chart
1.	8	1770	Light Emerald Green	Madeira Polyneon
2.	7	1648	Celery	Madeira Polyneon
3.	2	1922	Regal Purple	Madeira Polyneon
4.	3	1832	Majestic Purple	Madeira Polyneon
5.	5	1829	Blue Bird	Madeira Polyneon
6.	4	1830	China Blue	Madeira Polyneon
7.	9	1951	Pumpkin Chiffon	Madeira Polyneon

Machine runtime:

Module	Runtime (hr:min:sec)
Default	1:42:24



Design Worksheet

Zoom: 0.50

BERNINA Embroidery  
Software DesignerPlus

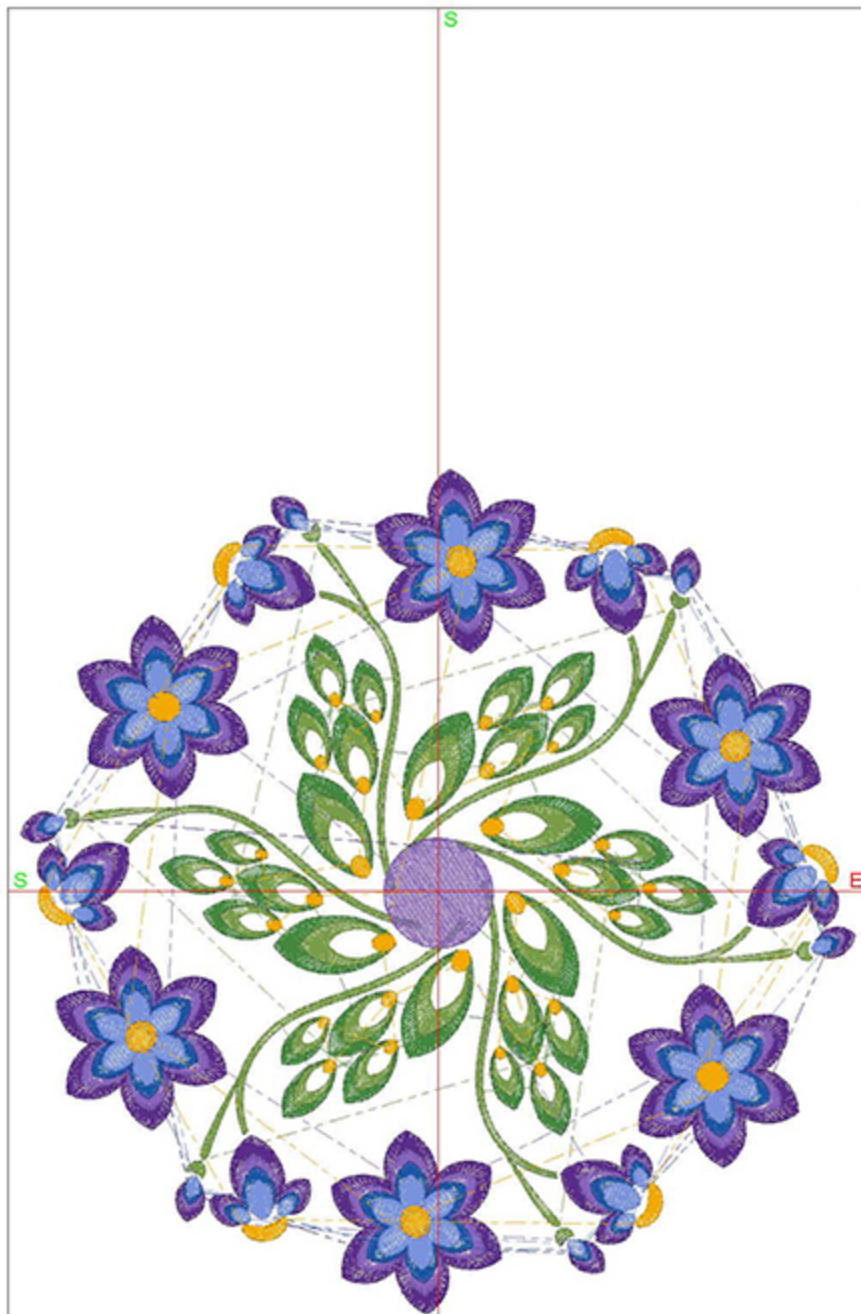

Name: BBISFlowerBlock10x10.ART

Height: 250.0 mm  
 Width: 247.0 mm  
 Stitches: 51945  
 Colors: 7  
 Color changes: 6  
 Trims: 174  
 Machine format: Bernina  
 Hoop: Medium (180 x 130)  
 Total bobbin: 130.08m

Color Sequence:

#	Color	Code	Name	Chart
1.	8	1770	Light Emerald Green	Madeira Polyneon
2.	7	1648	Celery	Madeira Polyneon
3.	2	1922	Regal Purple	Madeira Polyneon
4.	3	1832	Majestic Purple	Madeira Polyneon
5.	5	1829	Blue Bird	Madeira Polyneon
6.	4	1830	China Blue	Madeira Polyneon
7.	9	1951	Pumpkin Chiffon	Madeira Polyneon

Machine runtime:

Module	Runtime (hr:min:sec)
Default	2:37:49





Design Worksheet

Zoom: 0.51

BERNINA Embroidery  
Software DesignerPlus



Name: BBISLeavesBlock10x10.ART

Height: 250.0 mm  
 Width: 241.3 mm  
 Stitches: 61789  
 Colors: 7  
 Color changes: 7  
 Trims: 199  
 Machine format: Bernina  
 Hoop: Medium (180 x 130)  
 Total bobbin: 150.49m

Color Sequence:

#	Color	Code	Name	Chart
1.	8	1770	Light Emerald Green	Madeira Polyneon
2.	7	1648	Celery	Madeira Polyneon
3.	9	1951	Pumpkin Chiffon	Madeira Polyneon
4.	2	1922	Regal Purple	Madeira Polyneon
5.	3	1832	Majestic Purple	Madeira Polyneon
6.	5	1829	Blue Bird	Madeira Polyneon
7.	4	1830	China Blue	Madeira Polyneon
8.	9	1951	Pumpkin Chiffon	Madeira Polyneon

Machine runtime:

Module	Runtime (hr:min:sec)
Default	3:05:48



## Design Worksheet

BERNINA Embroidery Software DesignerPlus  
Design: BBISMultiLeavesBlock10x10

Stitches: 41932

Colors: 7

Height: 233.8 mm

Width: 250.0 mm

Zoom: 0,48

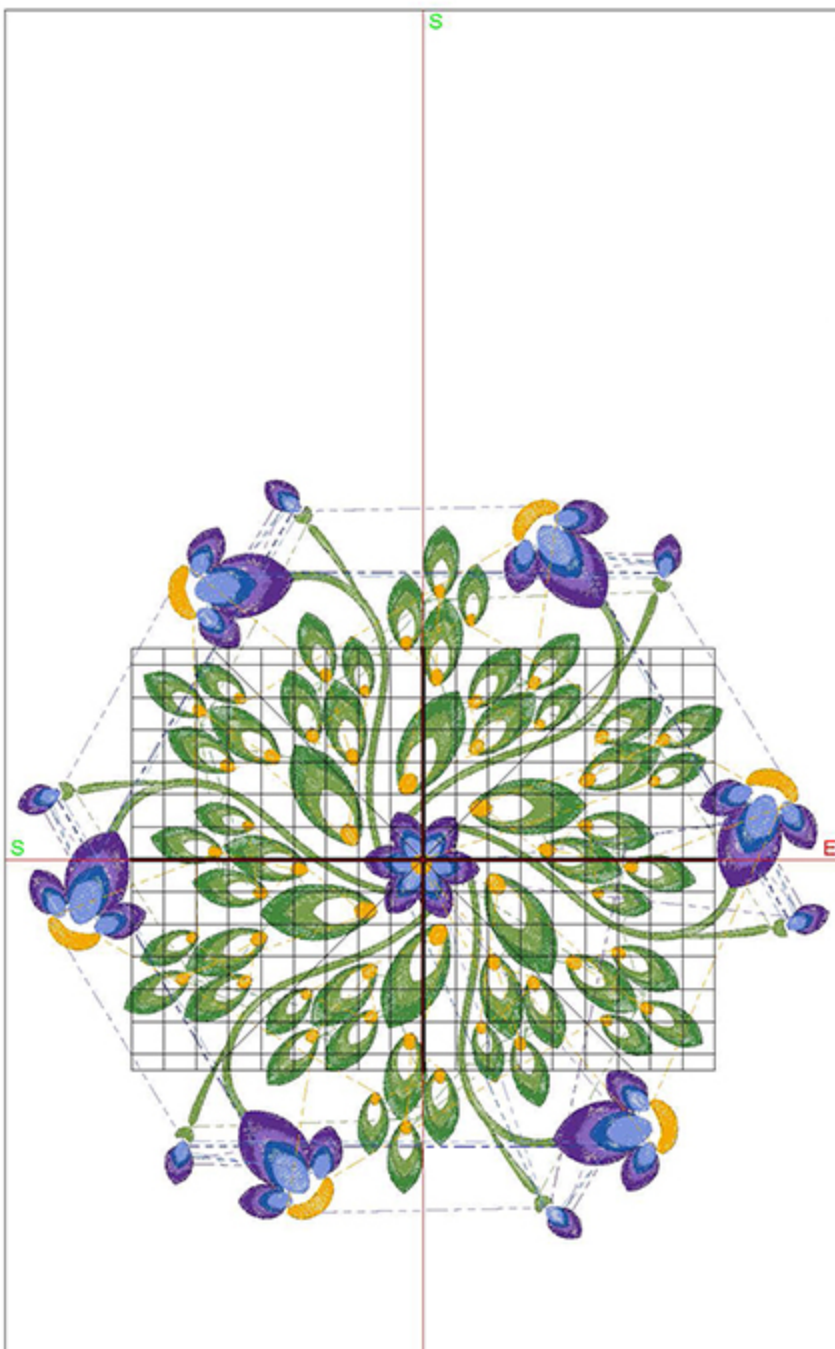

Total bobbin: 91.67m

Color Film:

#	Chart	Code	Name	Thread
1.	■	Madeira Polyneon 1770	Light Emerald Green	67.65m
2.	■	Madeira Polyneon 1648	Celery	73.66m
3.	■	Madeira Polyneon 1922	Regal Purple	31.54m
4.	■	Madeira Polyneon 1832	Majestic Purple	18.34m
5.	■	Madeira Polyneon 1829	Blue Bird	12.94m
6.	■	Madeira Polyneon 1830	China Blue	15.99m
7.	■	Madeira Polyneon 1951	Pumpkin Chiffon	18.43m

Machine runtime: 1:45:19



## Design Worksheet

BERNINA Embroidery Software DesignerPlus  
 Design: BBISPurpleCenterButterfly10x10

Stitches: 47939  
 Colors: 7  
 Height: 250.0 mm  
 Width: 242.4 mm  
 Zoom: 0.49

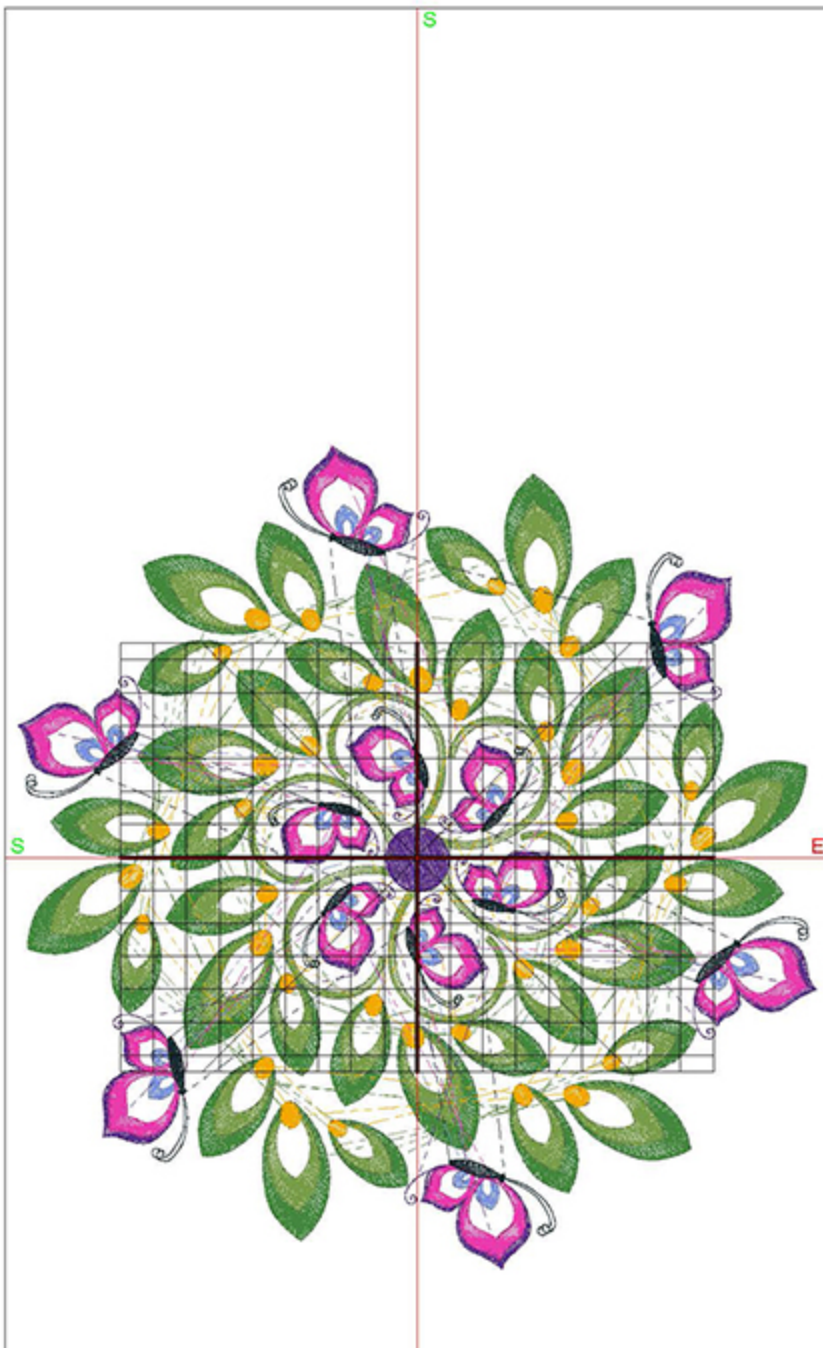

Total bobbin: 118.08m

Color Film:

#	Chart	Code	Name	Thread
1.	■	1770	Light Emerald Green	111.15m
2.	■	1648	Celery	98.00m
3.	■	1951	Pumpkin Chiffon	13.35m
4.	■	1830	China Blue	8.33m
5.	■	1922	Regal Purple	23.97m
6.	■	1709	Shocking Pink	28.94m
7.	■	1507	Pea Coat Lining	11.39m

Machine runtime: 1:44:29



## Design Worksheet

BERNINA Embroidery Software DesignerPlus  
Design: BBISWirlBlock10x10

Stitches: 60056  
Colors: 9  
Height: 250.0 mm  
Width: 248.0 mm  
Zoom: 0.47

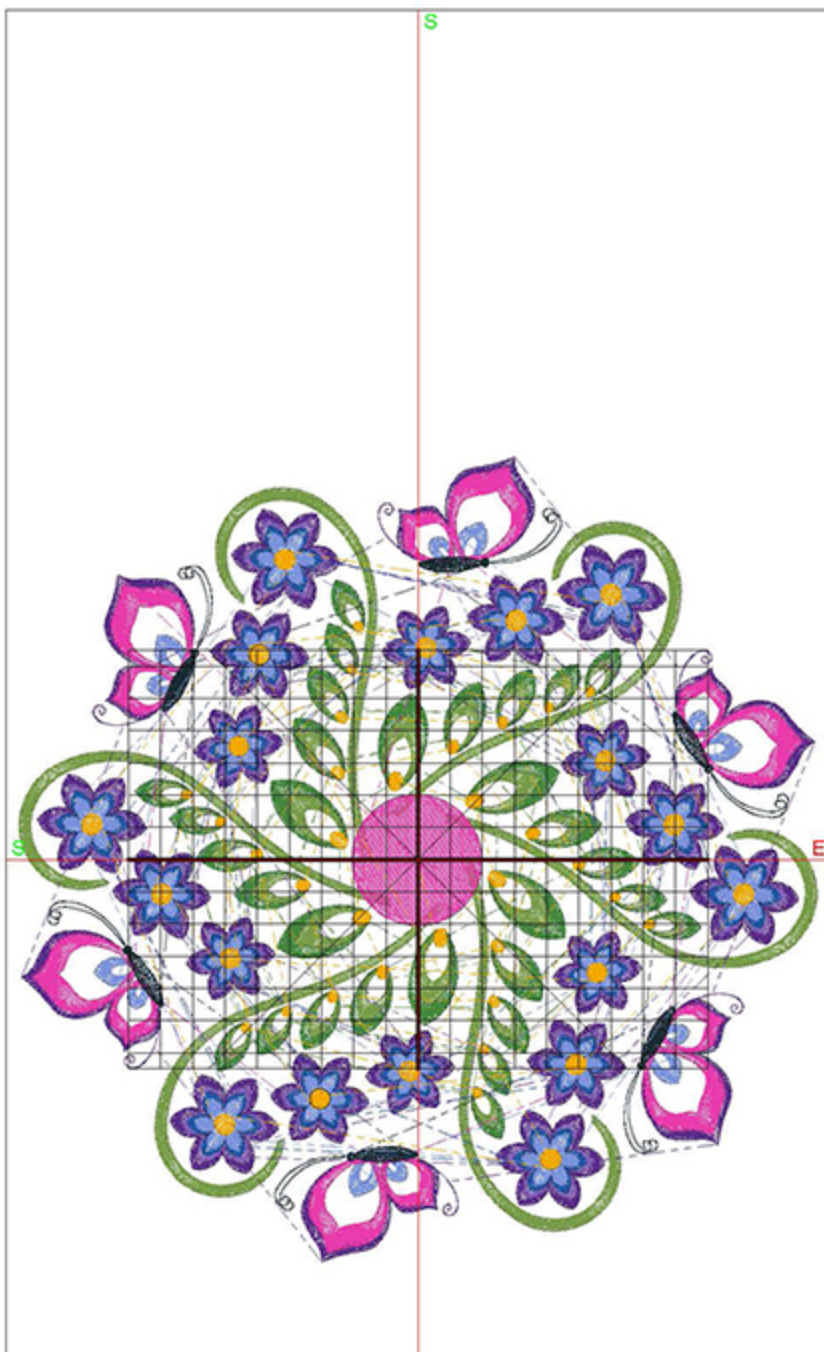

Total bobbin: 114.93m

Color Film:

#	Chart	Code	Name	Thread
1.	■	1770	Light Emerald Green	29.42m
2.	■	1648	Celery	55.78m
3.	■	1830	China Blue	7.02m
4.	■	1922	Regal Purple	16.81m
5.	■	1709	Shocking Pink	38.96m
6.	■	1507	Pea Coat Lining	9.05m
7.	■	1922	Regal Purple	57.58m
8.	■	1832	Majestic Purple	34.61m
9.	■	1829	Blue Bird	25.12m
10.	■	1830	China Blue	25.18m
11.	■	1951	Pumpkin Chiffon	14.52m

Machine runtime: 2:07:57



## Design Worksheet

BERNINA Embroidery Software DesignerPlus

Design: BBISWirlButterflyBlock10x10

Stitches: 52901

Colors: 9

Height: 242.6 mm

Width: 250.0 mm

Zoom: 0.47

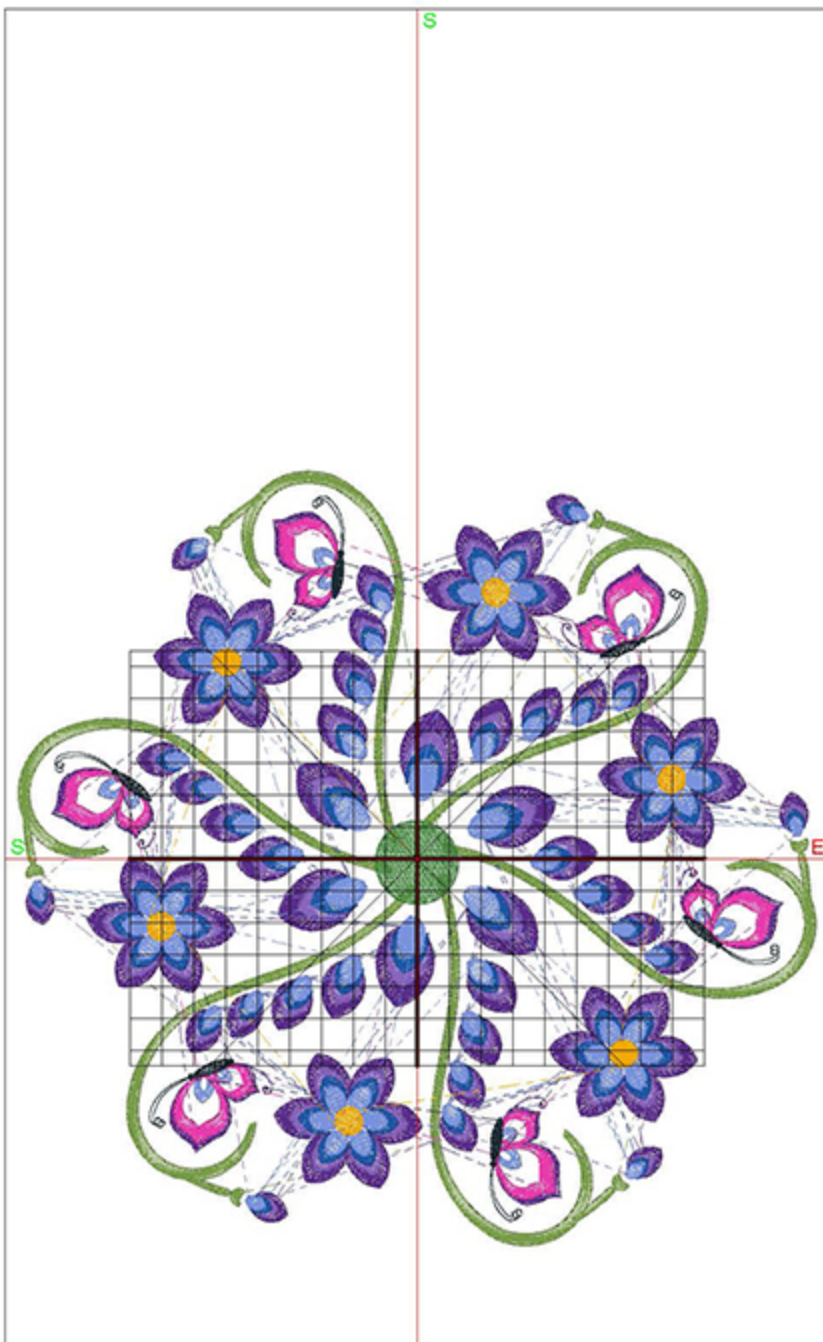

Total bobbin: 119.96m

Color Film:

#	Chart	Code	Name	Thread
1.		1648	Celery	36.48m
2.		1770	Light Emerald Green	5.93m
3.		1830	China Blue	4.05m
4.		1922	Regal Purple	9.81m
5.		1709	Shocking Pink	13.68m
6.		1507	Pea Coat Lining	5.51m
7.		1922	Regal Purple	94.56m
8.		1832	Majestic Purple	54.24m
9.		1829	Blue Bird	38.30m
10.		1830	China Blue	40.78m
11.		1951	Pumpkin Chiffon	4.89m

Machine runtime: 1:59:39